

ARMARIO DE EDUCAÇÃO FISICA

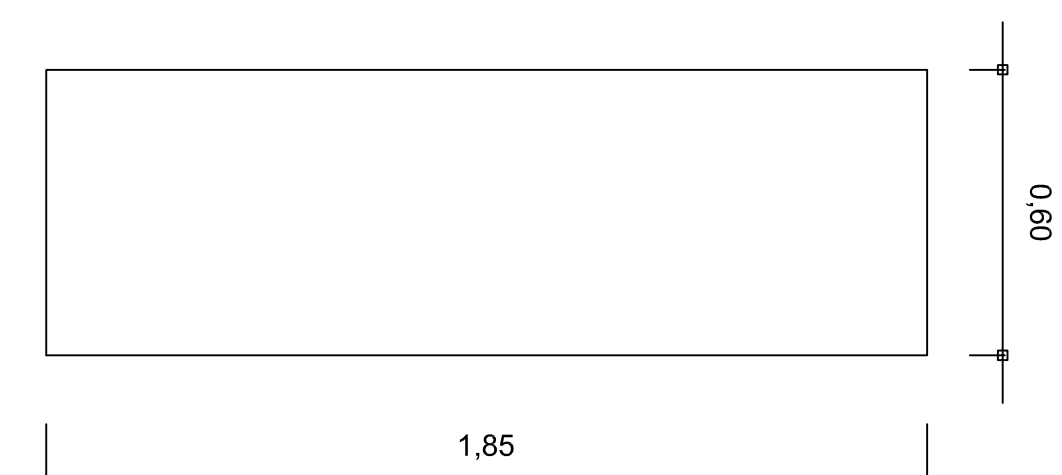
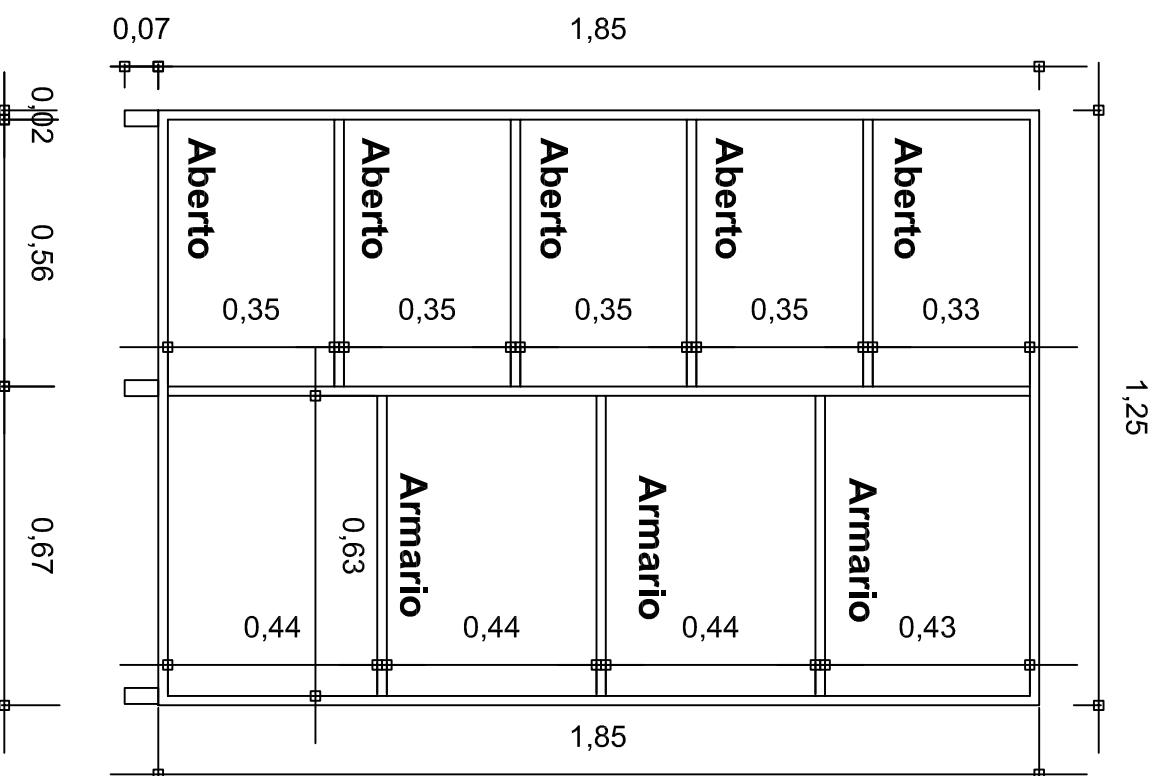
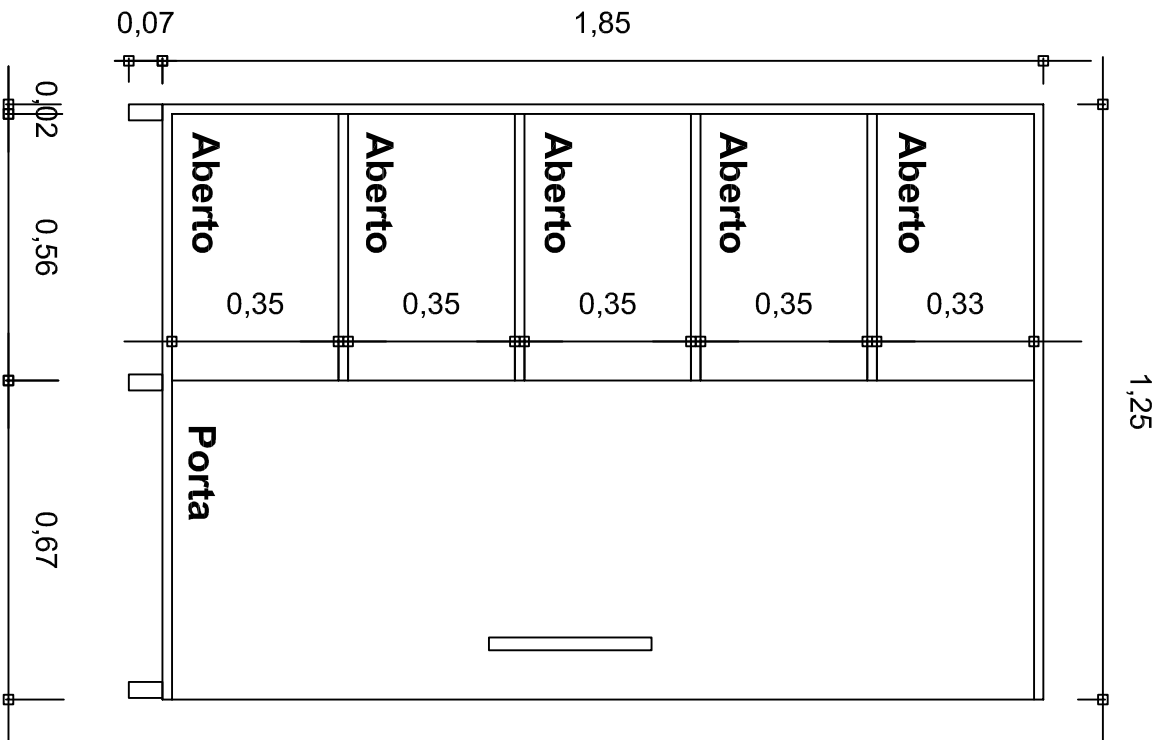

VISTA FRONTAL

VISTA FRONTAL INTERNA

VISTA LATERAL

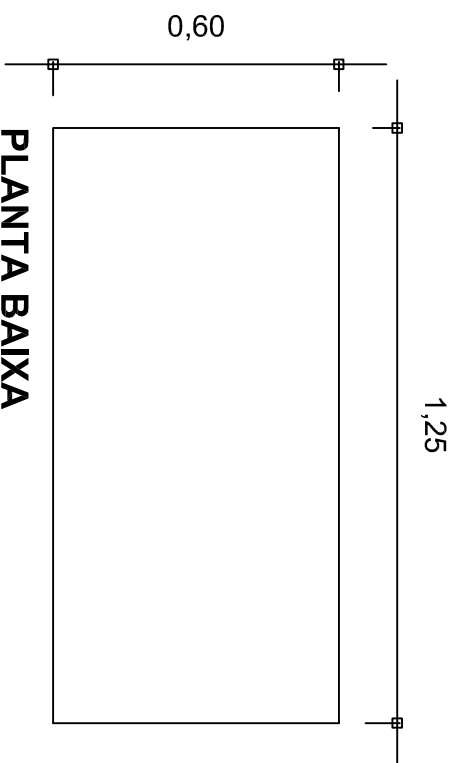

PLANTA BAIXA

CLIENTE

Prefeitura Municipal de Caiçá - Secretária da Educação

EDEVANE ELENA SCOPEL GUERINI

Arquiteta e Urbanista

CAU N° A40884-0

E-mail: edevanescopel@yahoo.com.br

LOCAL :

Pedro Ivo Campos

ÁREA DA EDIFICAÇÃO | RESPONSÁVEL - DESENHO

EDEVANE

DATA

Abri/2023

01